

Fittings

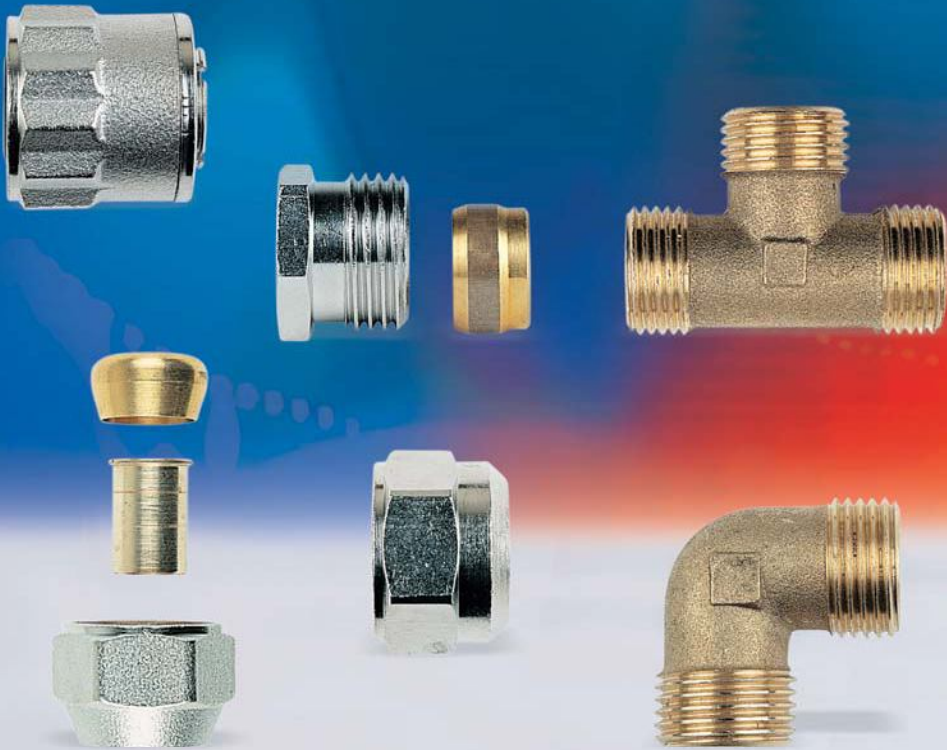

NIPPLES, ELBOW AND TEE UNIONS FOR POLYETHYLENE PIPES



DMP

Straight male connector for cross-linked polyethylene pipe.
Complete with brass CW617M cap and slotted double taper ferrule.
Max. pressure: 10 bar. Max. temperature: 110°C

Type	Part number	Size	Ø Tube	Min. order
DMP	1002312	1/2"	12 x 8	10
DMP	1002315	1/2"	15 x 10	10
DMP	1002316	1/2"	16 x 12	10
DMP	1002318	1/2"	18 x 13	10
DMP	1002319	1/2"	18 x 14	10
DMP	1002320	1/2"	20 x 16	10
DMP	1002422	3/4"	22 x 16	5
DMP	1002428	3/4"	28 x 22	5
DMP	1002532	1"	32 x 26	5
DMP	1002016	1/2"	16 x 11,6	5
DMP	1002020	1/2"	20 x 14,4	5
DMP	1002322	1/2"	22 x 16	5
DMP	1002999	3/4"	18 x 13	5
DMP	1002023	3/4"	20 x 16	5
DMP	1002021	3/4"	20 x 14,4	5
DMP	1002024	3/4"	25 x 20,4	5
DMP	1002025	3/4"	25 x 18	5



DIP

Straight bulkhead connector for cross-linked polyethylene pipe.
Characteristics like DMP.

Type	Part number	Size	Ø Tube	Min. order
DIP	1003012	1/2"	12 x 8	10
DIP	1003015	1/2"	15 x 10	10
DIP	1003016	1/2"	16 x 12	10
DIP	1003018	1/2"	18 x 13	10
DIP	1003019	1/2"	18 x 14	10
DIP	1003020	1/2"	20 x 16	10
DIP	1003022	3/4"	22 x 16	5
DIP	1003028	3/4"	28 x 22	5
DIP	1003032	1"	32 x 26	5
DIP	1003116	1/2"	16 x 11,6	5
DIP	1003120	1/2"	20 x 14,4	5
DIP	1003025	3/4"	25 x 20,4	5
DIP	1003125	3/4"	25 x 18	5

NIPPLES, ELBOW AND TEE UNIONS FOR POLYETHYLENE PIPES

DFP

Straight bulkhead connector, female connection, for cross-linked polyethylene pipe. Characteristics like DMP.

Type	Part number	Size	Ø Tube	Min. order
DFP	1004312	1/2"	12 x 8	10
DFP	1004315	1/2"	15 x 10	10
DFP	1004316	1/2"	16 x 12	10
DFP	1004318	1/2"	18 x 13	10
DFP	1004319	1/2"	18 x 14	10
DFP	1004320	1/2"	20 x 16	10
DFP	1004322	3/4"	22 x 16	5
DFP	1004328	3/4"	28 x 22	5
DFP	1004332	1"	32 x 26	5
DFP	1004016	1/2"	16 x 11,6	5
DFP	1004020	1/2"	20 x 14,4	5
DFP	1004019	3/4"	16 x 11,6	5
DFP	1004999	3/4"	18 x 13	5
DFP	1004023	3/4"	20 x 16	5
DFP	1004021	3/4"	20 x 14,4	5
DFP	1004422	3/4"	22 x 16	5
DFP	1004024	3/4"	25 x 20,4	5
DFP	1004025	3/4"	25 x 18	5

LMP

90° elbow, male connection, for cross-linked polyethylene pipe. Characteristics like DMP.

Type	Part number	Size	Ø Tube	Min. order
LMP	1005212	3/8"	12 x 8	10
LMP	1005315	1/2"	15 x 10	10
LMP	1005318	1/2"	18 x 13	10
LMP	1005422	3/4"	22 x 16	5
LMP	1005428	3/4"	28 x 22	5
LMP	1005532	1"	32 x 26	5
LMP	1005316	1/2"	16 x 12	5
LMP	1005016	1/2"	16 x 11,6	5
LMP	1005320	1/2"	20 x 16	5
LMP	1005020	1/2"	20 x 14,4	5
LMP	1005999	3/4"	18 x 13	5
LMP	1005023	3/4"	20 x 16	5
LMP	1005021	3/4"	20 x 14,4	5
LMP	1005024	3/4"	25 x 20,4	5
LMP	1005025	3/4"	25 x 18	5

NIPPLES, ELBOW AND TEE UNIONS FOR POLYETHYLENE PIPES



LIP

Bulkhead 90° elbow fitting for cross-linked polyethylene pipe. Characteristics like DMP.

Type	Part number	Size	Ø Tube	Min. order
LIP	1006012	3/8"	12 x 8	10
LIP	1006015	1/2"	15 x 10	10
LIP	1006018	1/2"	18 x 13	10
LIP	1006022	3/4"	22 x 16	5
LIP	1006028	3/4"	28 x 22	5
LIP	1006032	1"	32 x 26	5
LIP	1006016	1/2"	16 x 12	5
LIP	1006116	1/2"	16 x 11,6	5
LIP	1006020	1/2"	20 x 16	5
LIP	1006120	1/2"	20 x 14,4	5
LIP	1006025	3/4"	25 x 20,4	5
LIP	1006125	3/4"	25 x 18	5



LFP

90° elbow, female connection, for cross-linked polyethylene pipe. Characteristics like DMP.

Type	Part number	Size	Ø Tube	Min. order
LFP	1007212	3/8"	12 x 8	10
LFP	1007315	1/2"	15 x 10	10
LFP	1007318	1/2"	18 x 13	10
LFP	1007422	3/4"	22 x 16	5
LFP	1007428	3/4"	28 x 22	5
LFP	1007532	1"	32 x 26	5



TIP

Bulkhead Tee fitting for cross-linked polyethylene pipe. Characteristics like DMP.

Type	Part number	Size	Ø Tube	Min. order
TIP	1009012	3/8"	12 x 8	10
TIP	1009015	1/2"	15 x 10	10
TIP	1009018	1/2"	18 x 13	10
TIP	1009022	3/4"	22 x 16	5
TIP	1009028	3/4"	28 x 22	5
TIP	1009032	1"	32 x 26	5
TIP	1009016	1/2"	16 x 12	5
TIP	1009116	1/2"	16 x 11,6	5
TIP	1009020	1/2"	20 x 16	5
TIP	1009120	1/2"	20 x 14,4	5
TIP	1009025	3/4"	25 x 20,4	5
TIP	1009125	3/4"	25 x 18	5

NIPPLES, ELBOW AND TEE UNIONS FOR POLYETHYLENE PIPES

TFP

Tee fitting, female connection, for cross-linked polyethylene pipe. Characteristics like DMP.

Type	Part number	Size	Ø Tube	Min. order
TFP	1010315	1/2"	15 x 10	10
TFP	1010318	1/2"	18 x 13	10
TFP	1010422	3/4"	22 x 16	5
TFP	1010428	3/4"	28 x 22	5
TFP	1010532	1"	32 x 26	5
TFP	1010316	1/2"	16 x 12	5
TFP	1010016	1/2"	16 x 11,6	5
TFP	1010720	1/2"	20 x 16	5
TFP	1010020	1/2"	20 x 14,4	5
TFP	1010322	1/2"	22 x 16	5
TFP	1010999	3/4"	18 x 13	5
TFP	1010023	3/4"	20 x 16	5
TFP	1010021	3/4"	20 x 14,4	5
TFP	1010024	3/4"	25 x 20,4	5
TFP	1010025	3/4"	25 x 18	5

LFSP

90° elbow fitting complete with mounting bracket for cross-linked polyethylene pipe. Characteristics like DMP.

Type	Part number	Size	Ø Tube	Min. order
LFSP	1011315	1/2"	15 x 10	10
LFSP	1011318	1/2"	18 x 13	10
LFSP	1011316	1/2"	16 x 12	10
LFSP	1011317	1/2"	16 x 11,6	10

4D

Solder wire:
 standard (409D) 50% Pb - 50% Sn.
 extra (410D) 96.5% Sn - 3.5% Ag.

Type	Part number	Min. order
4D	409D	1
4D	410D	1



419D

Soldering paste. In 75 g. jars

Type	Part number	Min. order
419D	419D	1

OVERALL DIMENSIONS

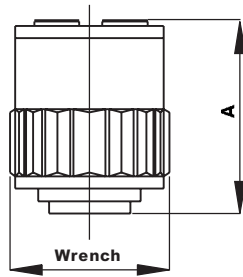
872M



DN	A	Rafit key
3/8"	25	20
1/2"	27	25
1/2"S	29	27

873M

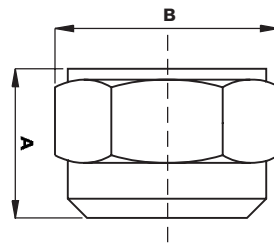

DN	A	B	Exagon Key
3/8" x 10	17.5	24	21
3/8" x 12	17	24	21
1/2" x 12	18.5	28	25
1/2" x 14	18.5	28	25
1/2" x 15	18.5	28	25
1/2" x 16	18	30	27
1/2"S x 18	17.5	30	27
3/4" x 18	18	30	--

820R

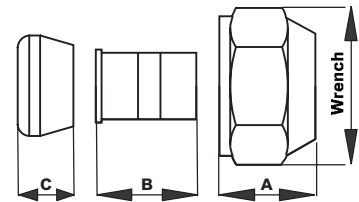

DN	A	B	C	Key
3/8"	17	24	9	20
1/2"	19	24	10	25
1/2"S	20	24	11	25
3/4"	20	24	11	32

197

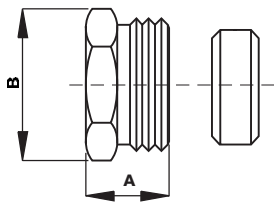

DN	A	B
3/8"	11	20
1/2"	14	24
3/4"	18	31

817M - 817MS

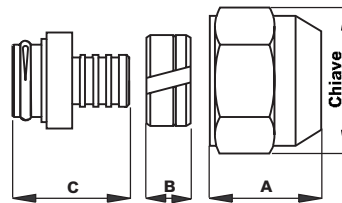

DN	A	B	C	Key
1/2"	23	8	21	20
1/2"S	26	8	22	25
3/4"	24	8	22	32

893GL

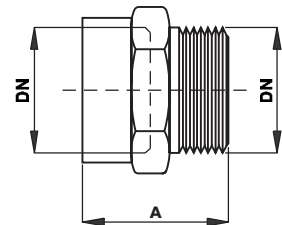

DN	A
1/4"	18
3/8"	20
1/2"	23
3/4"	32

892GL

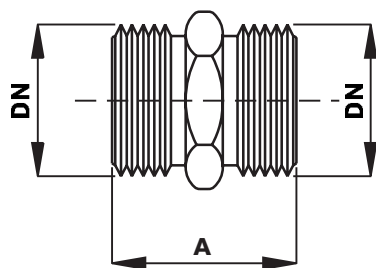

DN	A
1/4"	18
3/8"	22
1/2"	25
3/4"	28
1"	32

891GL

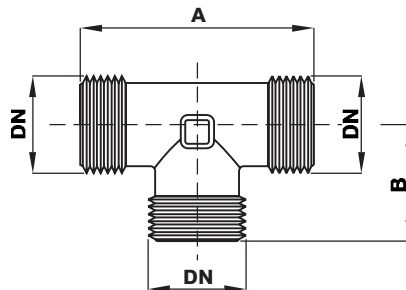

DN	A	B
3/8"	45	23
1/2"	51	25,5
3/4"	60	30

E891GL

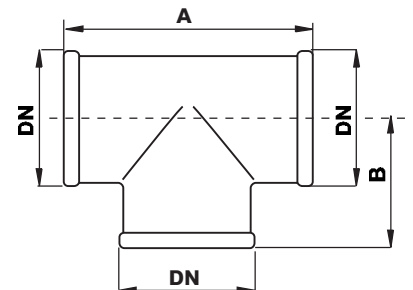

DN	A	B
3/8"	52	25
1/2"	62	29
3/4"	70	32

OVERALL DIMENSIONS

890GL

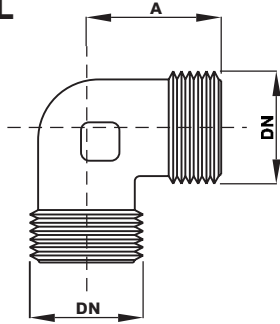

DN	A
3/8"	23
1/2"	26
3/4"	30

E890GL

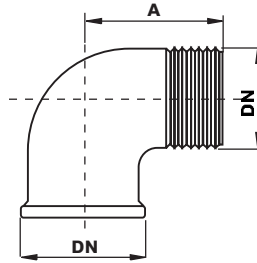

DN	A
1/2"	28
3/4"	31
1"	34

220

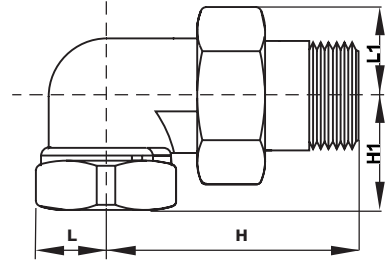

DN	H	H1	L	L1
3/8"MF	47	27	14	14
1/2"MF	53	34	16	18
3/4"MF	60	37	19	21
1"MF	77	46	23	27

221

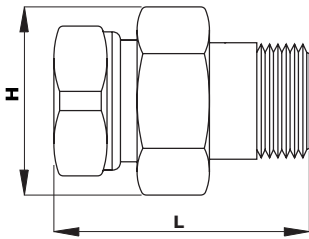

DN	H	L
3/8"MF	28	43
1/2"MF	35	51
3/4"MF	42	58
1"MF	54	62

833M

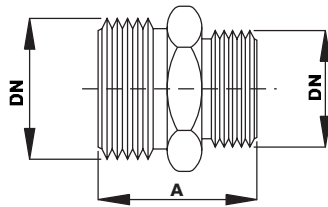

DN	A	DN	A
1/4" x 3/8"	20	1/2"S x 3/4"	30
3/8" x 1/2"	24	1/2" x 1"	34
3/8" x 3/4"	28	1/2"S x 1"	35
1/2"S x 1/2"	29	3/4" x 1"	35
1/2" x 3/4"	30		

821M

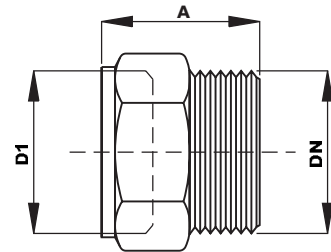

DN	D1	A	DN	D1	A
1/4"M	3/8"F	21	1/2"M	1"F	21
3/8"M	1/4"F	21	3/4"M	1"F	21
3/8"M	1/2"F	21	1"M	1/8"F	21
1/2"M	3/8"F	22	1"M	1/4"F	22
1/2"SM	1/2"F	24	1"M	3/8"F	24
1/2"M	3/4"F	25	1.1/4"M	1"F	25

841M

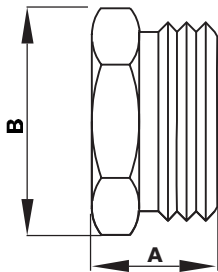

DN	A	B
3/8"	13	21
1/2"	15	27
3/4"	16	30
1"	22	37
1.1/4"	23	50

834M

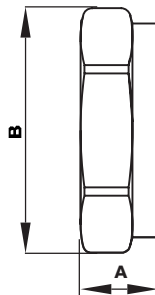

DN	A	B
3/8"	7	19
1/2"	9	25
3/4"	18	32
1"	18	38

842M

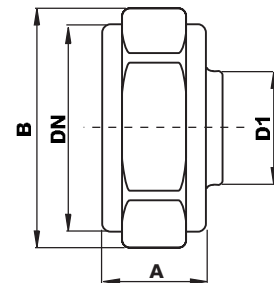

DN	D1	A	B
1"F	1/4"F	26	38
1"F	3/8"F	21	38

